



*In the Tradition of
the Franciscan Fathers and
Sisters of the Precious Blood*

Saint Mary's High School

2525 North Third Street • Phoenix, Arizona 85004-1339

Phone (602) 251-2500 • Fax (602) 251-2595

www.smknights.org

"Home of the Knights"

August 4, 2009

Dear Parents and Students,

Enclosed with this letter you will find a [color-coded map](#) of the new **Traffic Flow/Drop-Off/Pick-Up** plan which has been developed for Saint Mary's High School. Please take time to study it with your student(s) and develop your own appropriate "family plan" that you will use in order to most efficiently implement the school plan.

Some highly recommend suggestions for using this plan are:

1. If you enter off of 7th Street try to plan to exit off of 7th Street.
2. If you enter off of 3rd Street try to plan to exit off of 3rd Street.
3. For the safety of all students, please drop-off and pick-up your students only in the designated areas for doing so...on the north side of Sheridan Street next to the gymnasium and on the sidewalk area on the east side of Piper Hall. Signs will be posted.

Even though there are directions for entering and exiting from 3rd Street to 7th Street and 7th Street to 3rd Street, we would very much like to try to keep the traffic flow THROUGH the Student Park Lot to a minimum for safety and efficiency purposes.

PARENTS DOING DROP/OFF OR PICK UP: PLEASE USE ONLY THE PERIMETER ROUTES IF YOU DO NEED TO DRIVE THROUGH THE PARKING LOT. DO NOT ENTER ANY AREAS THAT ARE NOT MARKED WITH TRAFFIC FLOW ARROWS ON THE MAP.

All student drivers will have a mandatory meeting at the end of their class run through on the August 10th Orientation Day. Administration will provide specific directions, maps, and information to students and answer any questions they may have.

There will be school staff and sheriff/police officers assisting in directing traffic in key areas. Please follow their directions at all times. School staff and administration will be monitoring the flow patterns carefully over the beginning weeks of school. If adjustments need to be made, those new adjustments and instructions will be given to students and parents.

Please remember, one of the key pieces which will help to make this plan be most successful is that: "A student should be WAITING for their parent/ride to pick them up—the parent/ride should NOT be WAITING for the student to show up. "

Thank you ahead of time for the cooperation I know we will receive from each of you.

Sincerely,

Mrs. Suzanne Fessler

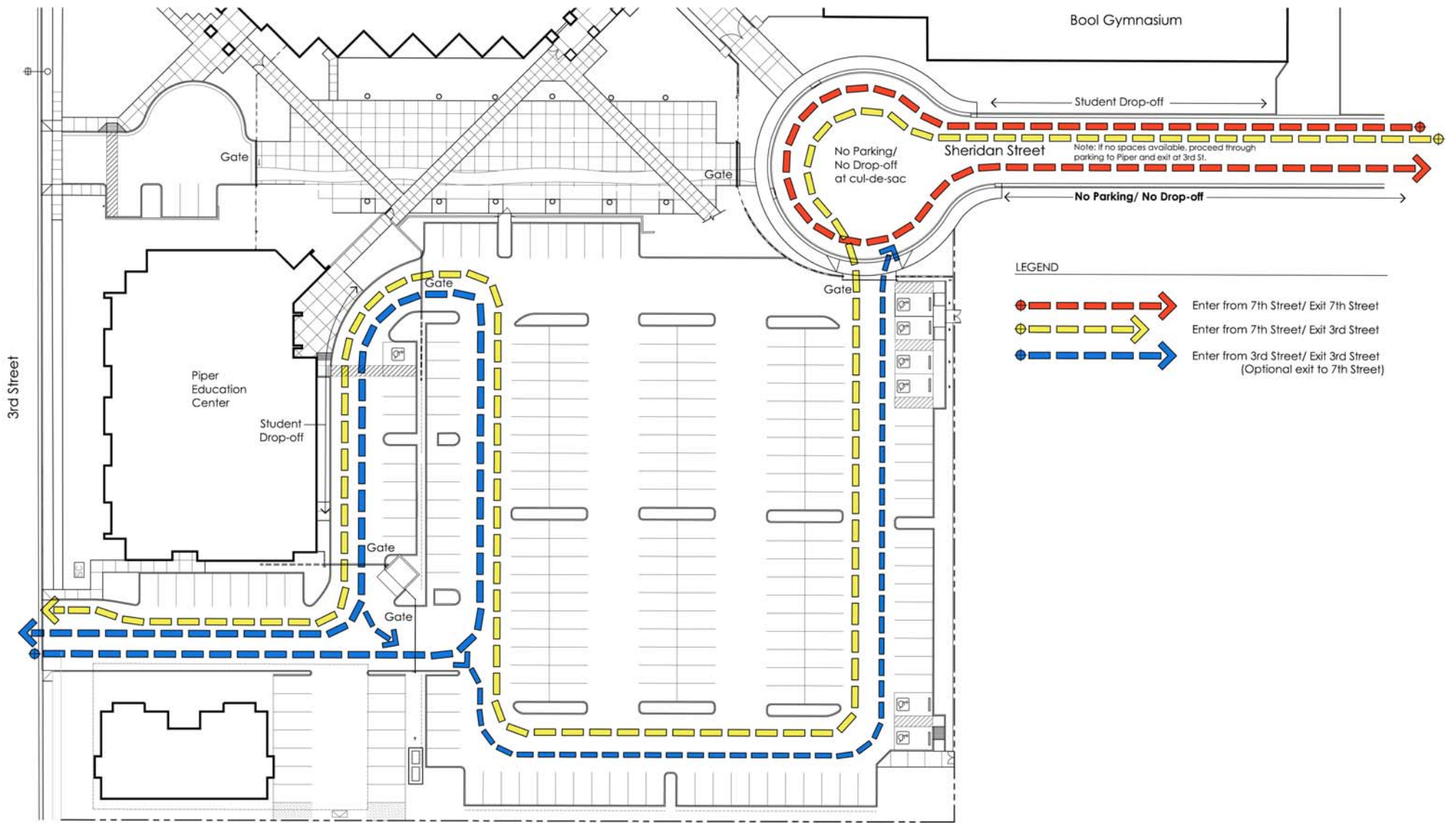

VEHICULAR CIRCULATION PLAN

St. Mary's High School

Project No. 07-9002-02 Date July 31, 2009

Todd & Associates, Inc. 402-952-8280 www.toddassoc.com

